

ROSALA AVENUE

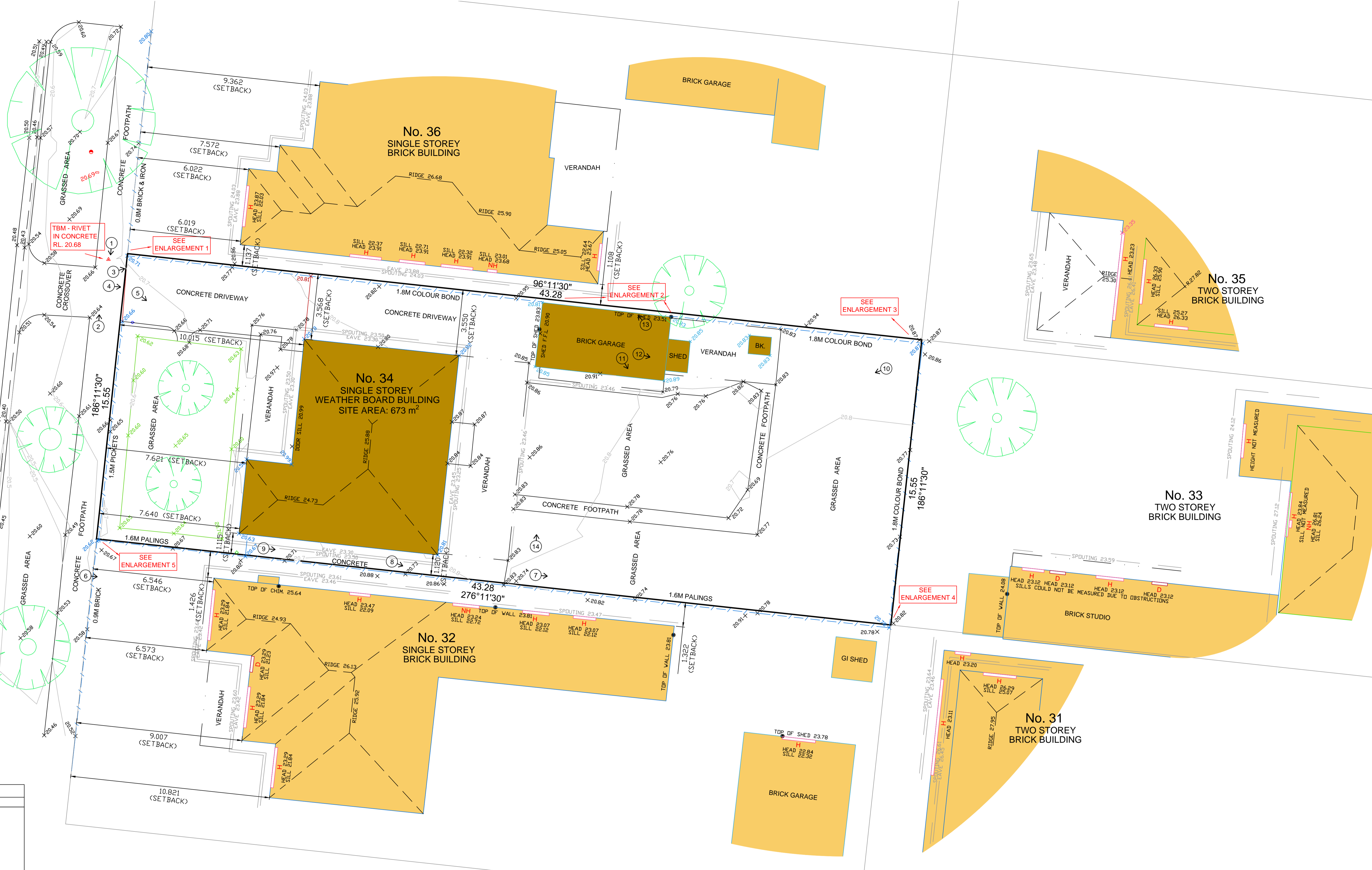

LEGEND		
SYM	LINE	LAYER NAME
X	4	Control
X	104	Natural Surface
X	107	Floor Level
X	108	Sill Level
X	110	Breakline
X	201	Tree
X	205	Garden
X	406	Lip of Kerb
X	407	Invert of Kerb
X	408	Back of Kerb
X	410	Path
X	413	Edge of Concrete
X	602	Shed
X	603	Major Building
X	604	Verandah
X	605	Ridge
X	606	Spouting
X	607	Eave
X	608	Parapet
X	611	Window
X	612	Door
X	615	Retaining Wall - Brick
X	617	Stairs
X	713	Electricity Pole with Light
X	721	Telecom Pit
X	735	Gas Meter
X	754	Water Meter
X	901	Title Boundary
X	903	Fence
X	904	Gate
H		DCMB Lot (Indicative Only)
NH		Habitable Window
U		Non-Habitable Window
		Unknown Window

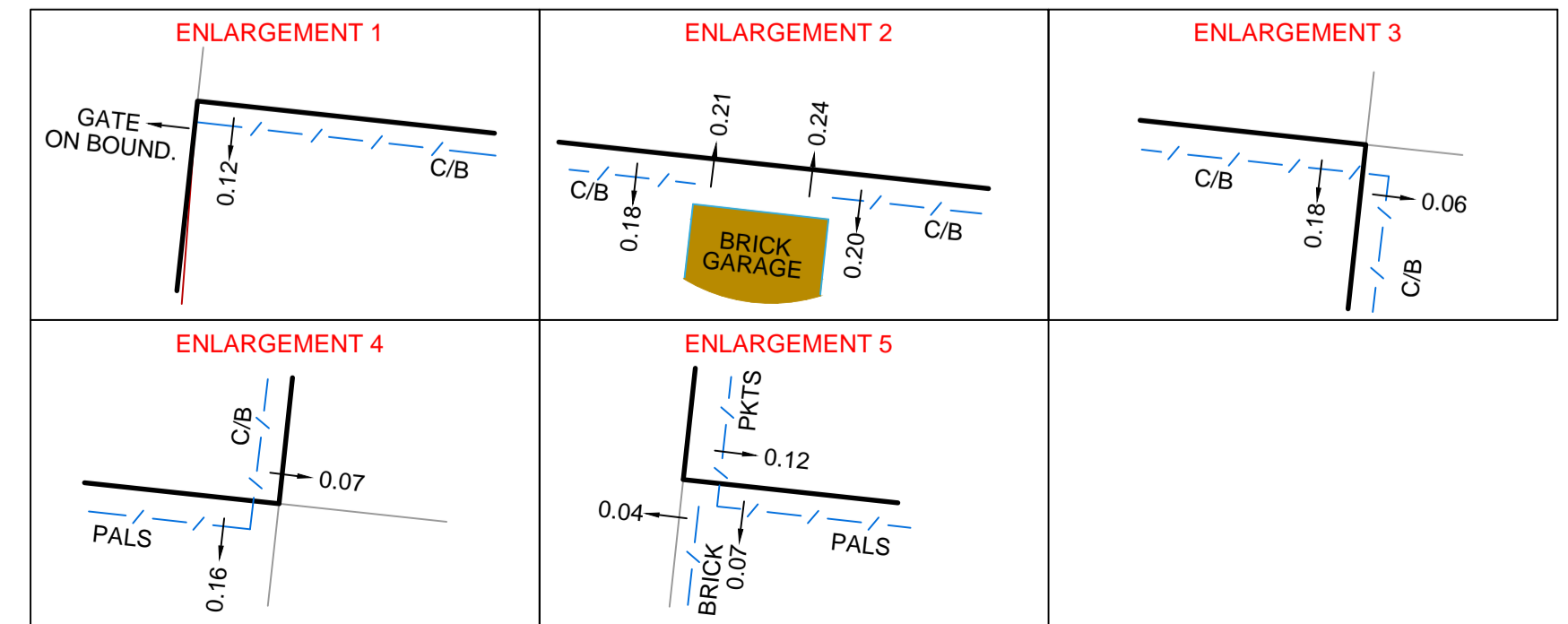
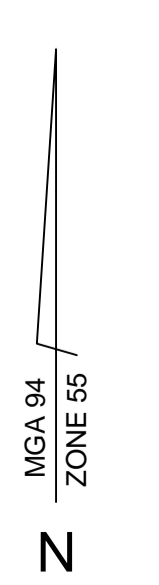

NOTATIONS
 This Plan must be read together with the attached Licensed Surveyor's Report.
 Location of buildings outside the subject site are indicative only
 All grey lines representing neighbouring property boundaries are from Vicmap Property and are indicative only.
 Relationship between occupations and boundaries exaggerated for illustrative purposes.

Levels are to the Australian Height Datum (AHD) through connection to MMB 6253 (RL.17.760m)
 Certain layers have been frozen for clarity but can be thawed if required
 Contour interval 0.1m

CLIENT
 JOE ASTORINO
 PROJECT
 34 ROSALA AVENUE
 ALTONA NORTH
 CERTIFICATE OF TITLE
 C/T Vol. 8380 Fol. 972
 PROJECT DETAILS
 Title Re-establishment,
 Feature and Level Survey

Scale 1:100	1 0.5 0 1 2 3	Sheet Size: A1
Date: 03/08/2020	Date of Survey: 31/07/2020	
Drawn: JE	Surveyor: PB	
Licensed Surveyor: Luke Mackie		
Sheet 1 of 1	Drawing No.: 253400AA	
Version A		

Mackie Surveying

150 Victoria Street
 Seddon 3011
 P. 1300 663 676
 luke@mackiesurveying.com